

## NOTICE OF HEARING

### Village of Greendale Tax Incremental District

NOTICE IS HEREBY GIVEN that a public hearing will be held before the Plan Commission on Tuesday, February 16, 2010, in the Court Room of the Greendale Safety Center located at 5911 W. Grange Avenue in Greendale, WI at 7:00 p.m. (Or as soon thereafter as is practical) to consider the creation of Tax Incremental District Number One, Village of Greendale, including proposed boundaries and Project Plan therefore.

The proposed Tax Incremental District Number One, Village of Greendale, is comprised of approximately 25 acres and located in the vicinity of 5400 South 76<sup>th</sup> Street (southern portion of the Southridge Mall property) as shown on the map below:

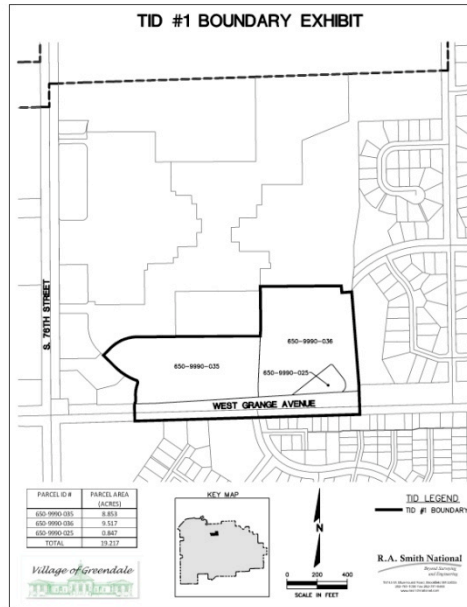

At the Public Hearing interested parties will be afforded a reasonable opportunity to express their views on the proposed creation of Tax Incremental District Number One, Village of Greendale, the proposed boundaries thereof, and the proposed Project Plan.

The redevelopment of these properties could likely not occur without the use of Tax Incremental Financing. The proposed Project Plan's project costs may include cash grants to owners, lessees, or developers of land located within the District.

A copy of the proposed Project Plan will be provided upon request. Such requests should be addressed to the Village Manager, 6500 Northway, Greendale, WI 53129.

This notice of Public Hearing is given pursuant to Sections 66.1105(4)(a) and (e) of the Wisconsin Statutes, as amended.

Notice is hereby given that a majority of the Village Board and Community Development Authority may be present to gather information on a subject over which they may have decision making responsibility.

Dated at Greendale, Wisconsin, this 22<sup>nd</sup> day of January 2010.

**/s/ Kathryn Kasza**  
**Clerk-Treasurer**  
**Village of Greendale**

Publication Dates:  
January 28, 2010  
February 4, 2010