

NOTES:

- 1 SEE STANDARD DETAIL DRAWINGS FOR BARRICADES, SIGNS AND TRAFFIC CONTROL DETAILS.
2. COORDINATE TRAFFIC CONTROL WITH ADJACENT PROJECT ON W. LOOMIS ROAD.

STAGE 1 WORK ZONE  
LOOMIS ROAD TO COLLEGE PARK SCHOOL

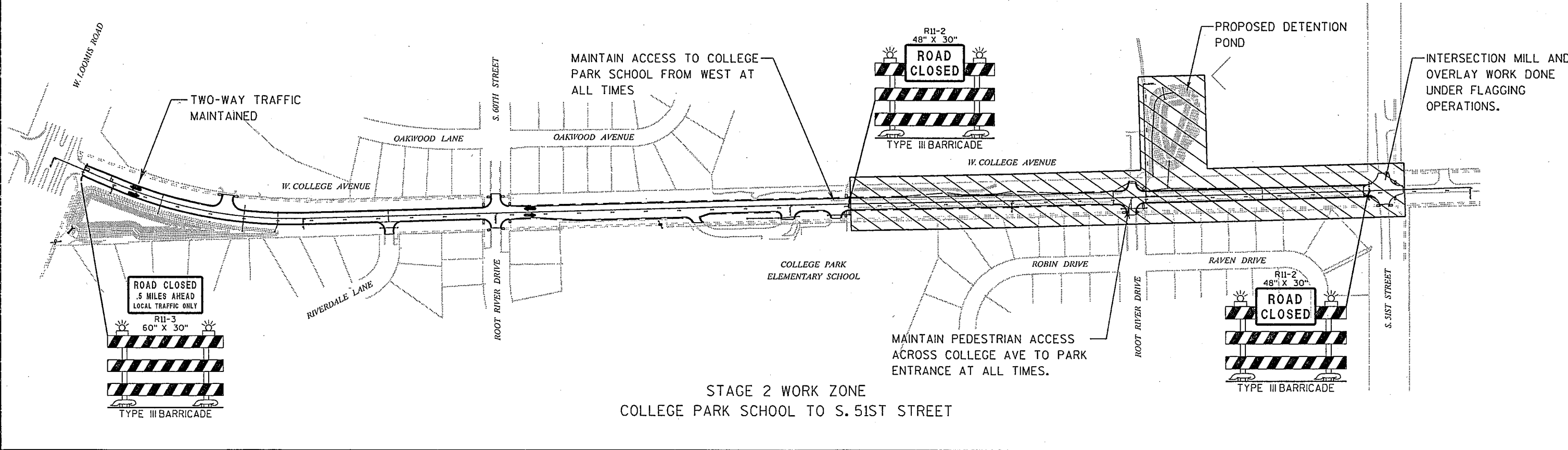

STAGE 2 WORK ZONE  
COLLEGE PARK SCHOOL TO S. 51ST STREET

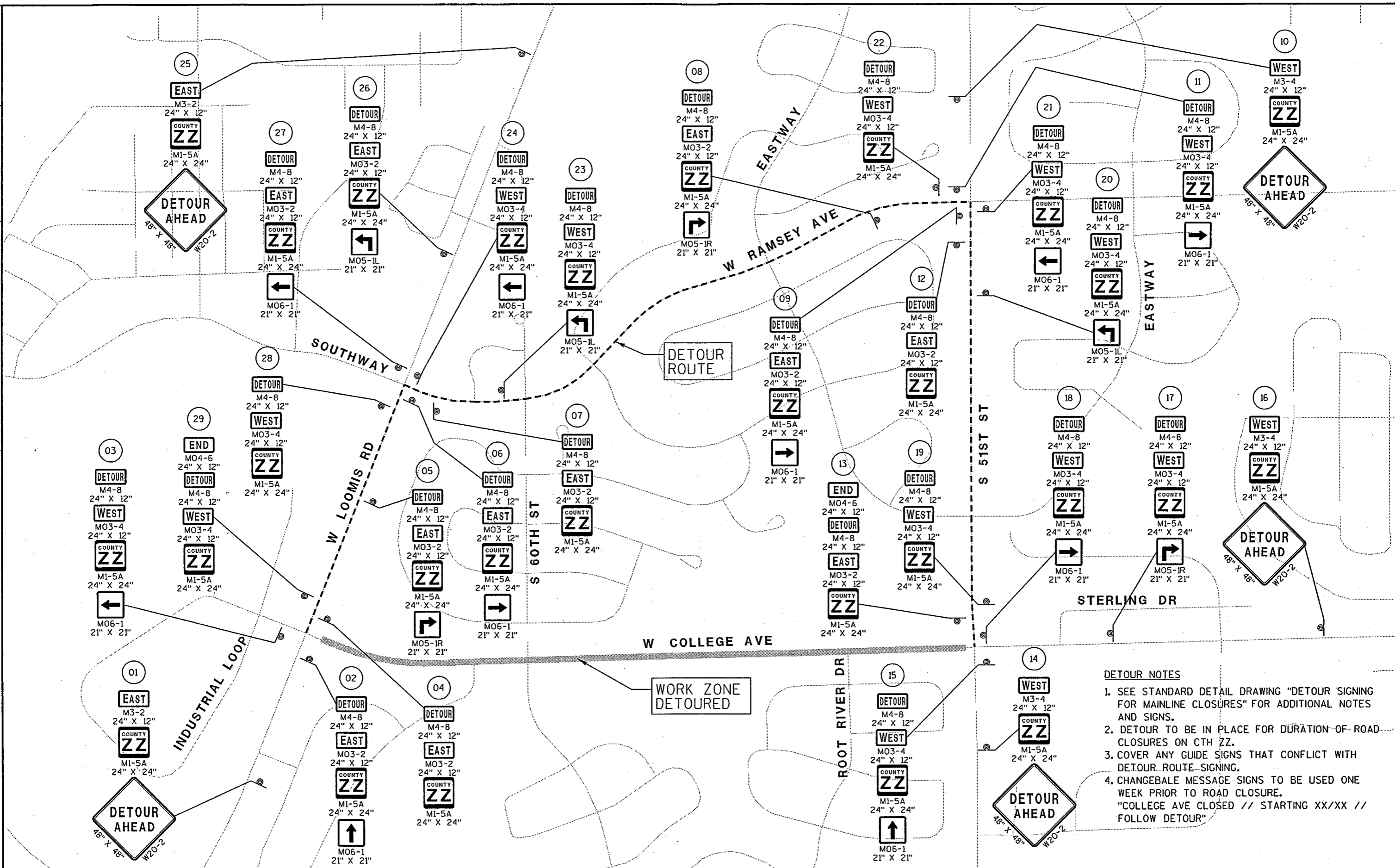

**DETOUR NOTES**

1. SEE STANDARD DETAIL DRAWING "DETOUR SIGNING FOR MAINLINE CLOSURES" FOR ADDITIONAL NOTES AND SIGNS.
2. DETOUR TO BE IN PLACE FOR DURATION OF ROAD CLOSURES ON CTH ZZ.
3. COVER ANY GUIDE SIGNS THAT CONFLICT WITH DETOUR ROUTE SIGNING.
4. CHANGEABLE MESSAGE SIGNS TO BE USED ONE WEEK PRIOR TO ROAD CLOSURE. "COLLEGE AVE CLOSED // STARTING XX/XX // FOLLOW DETOUR"